



FITTING INSTRUCTIONS FOR LP0254BK LICENCE PLATE BRACKET
HONDA CB1000R '18-



THIS KIT CONTAINS THE ITEMS PICTURED AND LABELLED BELOW.
DO NOT PROCEED UNTIL YOU ARE SURE ALL PARTS ARE PRESENT.

Please note that the way the kit is packed does not necessarily represent the way of mounting to the bike.

THE PARTS SHOWN MAY BE REPRESENTATIVE ONLY (FOR CLARITY OF INSTRUCTIONS ONLY).

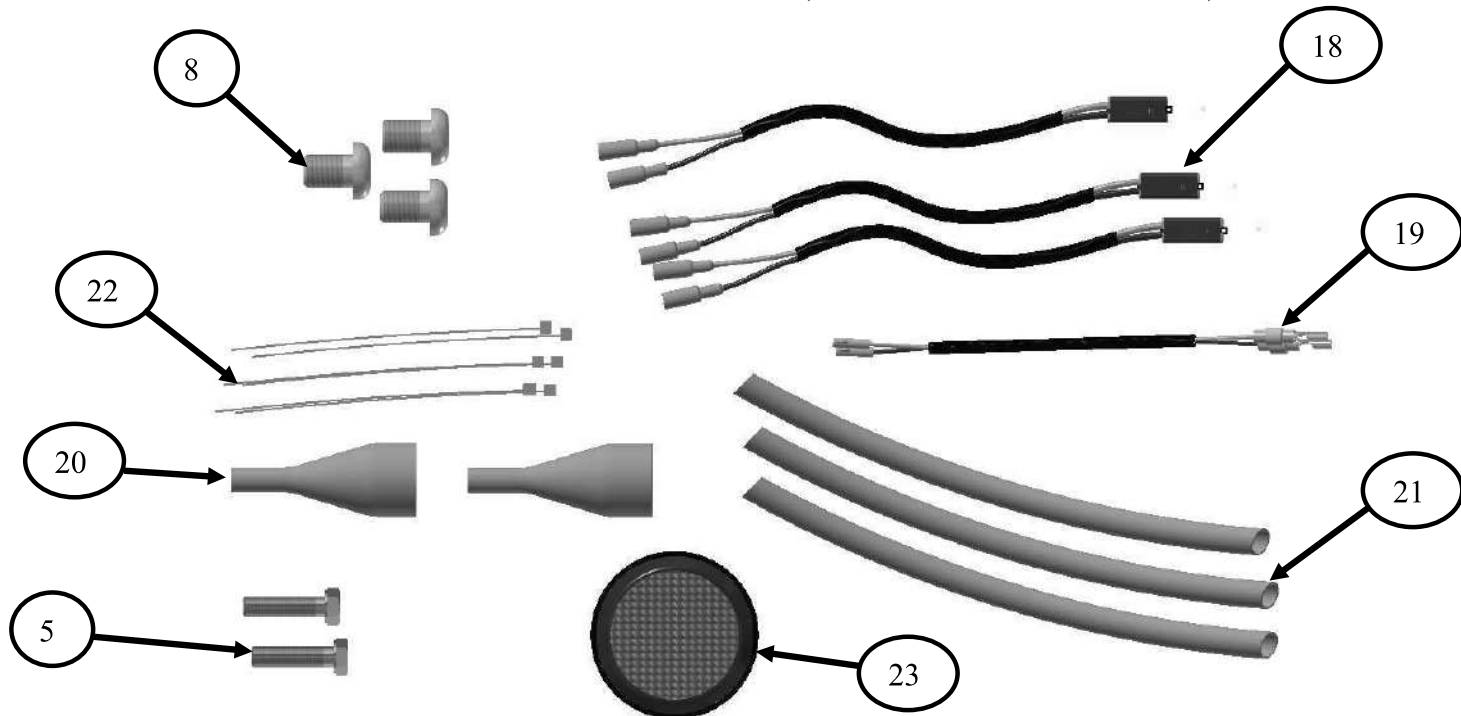

R&G

Unit 1, Shelley's Lane, East Worldham, Alton, Hampshire, GU34 3AQ
 Tel: +44 (0)1420 89007 Fax: +44 (0)1420 87301 www.rg-racing.com Email: info@rg-racing.com

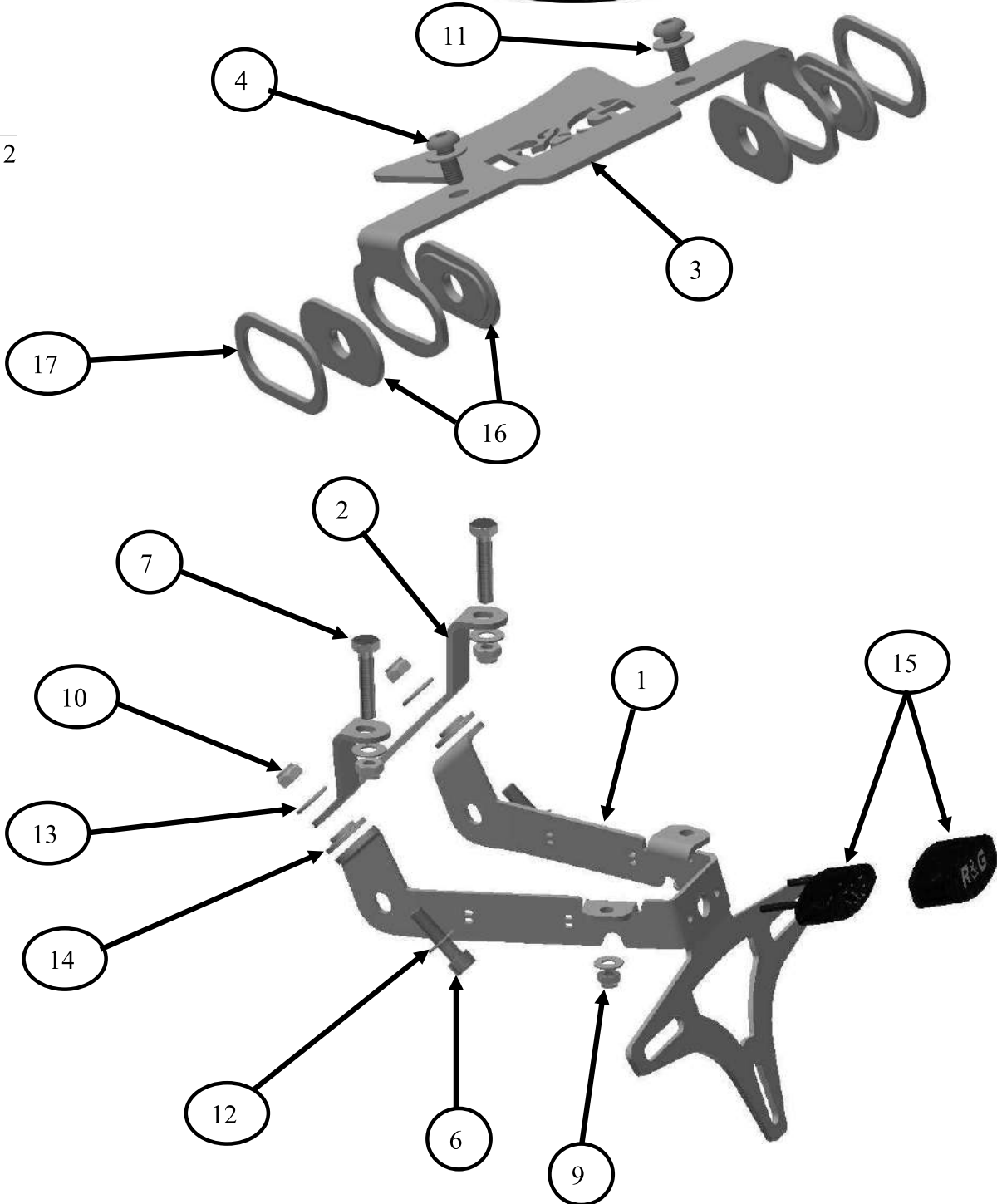



LEGEND

Page | 3

ITEM 1 = LICENCE PLATE BRACKET (TB0254 PART 1) (x1).
 ITEM 2 = INTERNAL SUPPORT BRACKET (TB0254 PART 2) (x1).
 ITEM 3 = INDICATOR MOUNT BRACKET (TB0254 PART 3) (x1).
 ITEM 4 = M5 x 0.8 x 15mm LONG BUTTON HEAD BOLTS (x2).
 ITEM 5 = M5 x 0.8 x 20mm LONG HEX HEAD BOLTS (x2).
 ITEM 6 = M6 x 1.0 x 25mm LONG CAP HEAD BOLTS (x2).
 ITEM 7 = M6 x 1.0 x 30mm LONG HEX HEAD BOLTS (x2).
 ITEM 8 = M8 x 1.25 x 12mm LONG BUTTON HEAD BOLTS (x3).
 ITEM 9 = M5 NYLOC NUTS (x2).
 ITEM 10 = M6 NYLOC NUTS (x4).
 ITEM 11 = 12mm M5 WASHERS (x4)
 ITEM 12 = 12mm M6 WASHERS (x4)
 ITEM 13 = 16mm M6 WASHERS (x2)
 ITEM 14 = 4MM LONG STEPPED SPACERS (S1136) (x2)
 ITEM 15 = LICENCE PLATE ILLUMINATOR ASSEMBLY (x1)
 ITEM 16 = MINI INDICATOR ADAPTORS (I0034) (x4).
 ITEM 17 = OEM INDICATOR SPACERS (I0032) (x2).
 ITEM 18 = INDICATOR/LICENCE PLATE ILLUMINATOR CONNECTORS (CON0059) (x3).
 ITEM 19 = LICENCE PLATE ILLUMINATOR CONNECTOR EXTENSIONS (CON0044) (x1).
 ITEM 20 = INDICATOR WIRING COVERS (IWC0002) (x2)
 ITEM 21 = 200MM LENGTHS OF HEATSHRINK (x3).
 ITEM 22 = SMALL CABLE TIES (x6).
 ITEM 23 = REFLECTOR (x1).

TOOLS REQUIRED

- Metric socket set including 8mm, 10mm.
- Metric allen key set including 6mm, 8mm.
 - Metric spanner to including 13mm.
 - Small flat head screwdriver.
 - Phillips head screwdriver.
- Wire cutters (Optional-see fitting instructions)
- Swingarm pivot stand (Optional-see fitting instructions)
 - Torque wrench.

MAXIMUM TORQUE SETTINGS

- M4 BOLT = 8Nm
- M5 BOLT = 12Nm
- M6 BOLT = 15Nm
- M8 BOLT = 20Nm
- M10 BOLT = 40Nm

R&G

Unit 1, Shelley's Lane, East Worldham, Alton, Hampshire, GU34 3AQ
 Tel: +44 (0)1420 89007 Fax: +44 (0)1420 87301 www.rg-racing.com Email: info@rg-racing.com



Picture 1

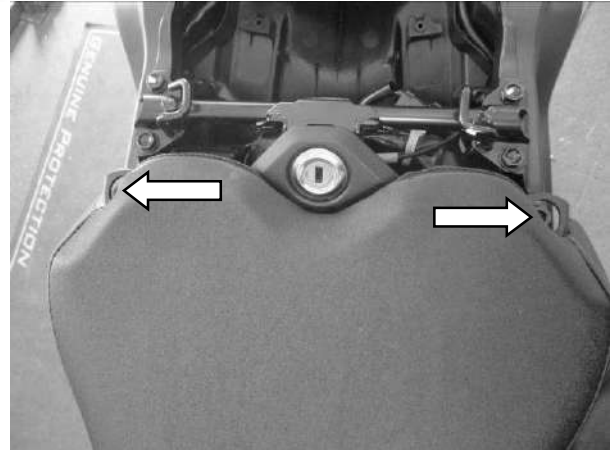

Picture 2

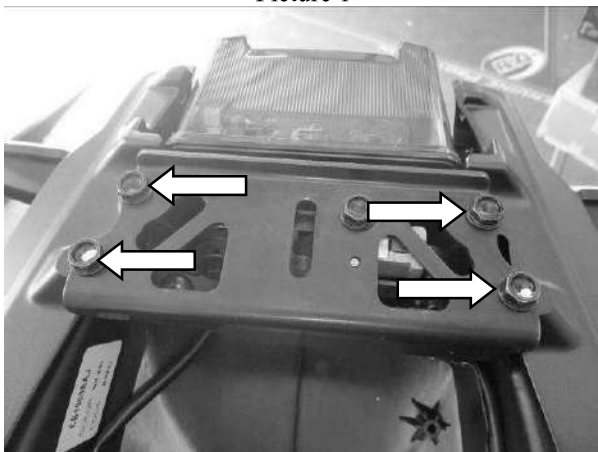

Picture 3



Picture 4



Picture 5

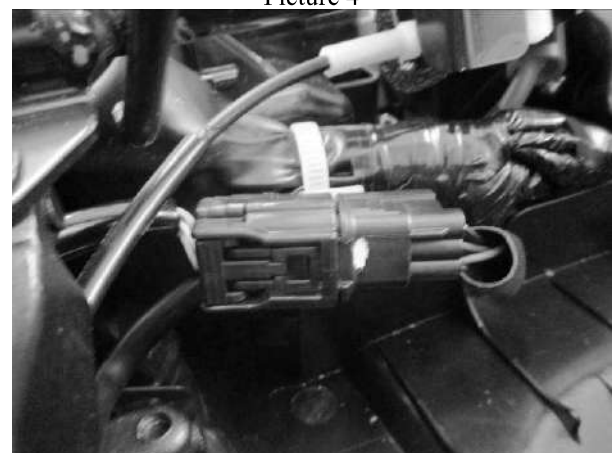

Picture 6

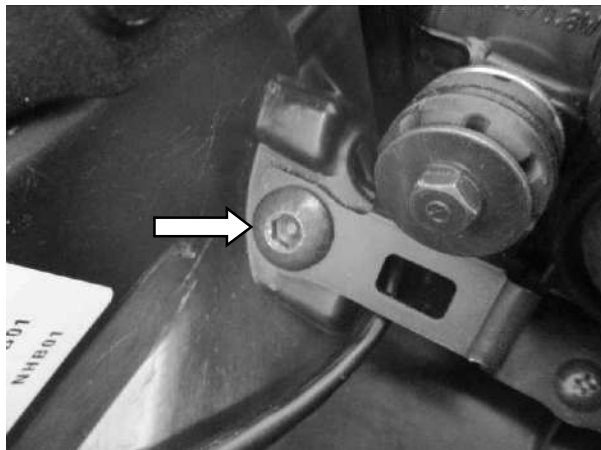

Picture 7

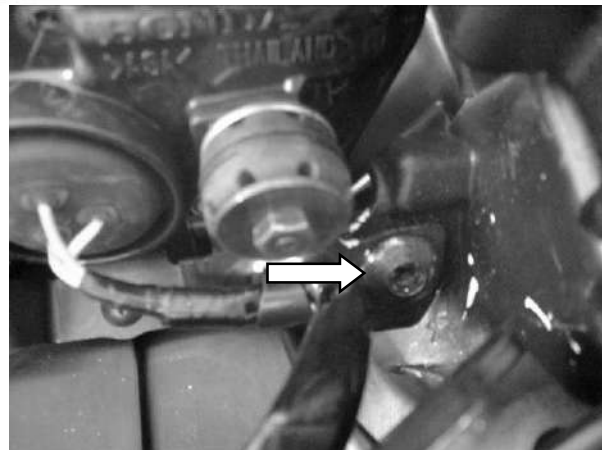

Picture 8

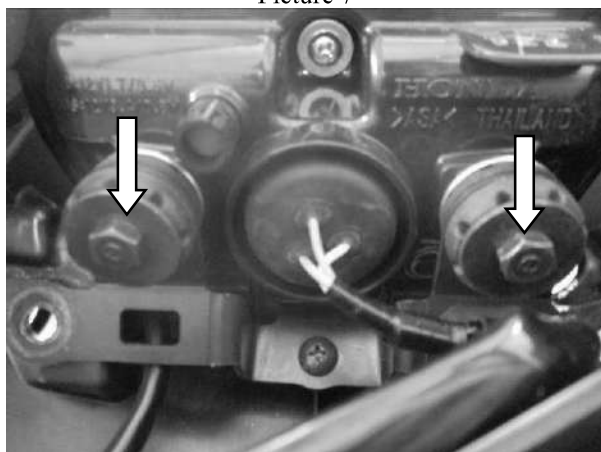

Picture 9



Picture 10

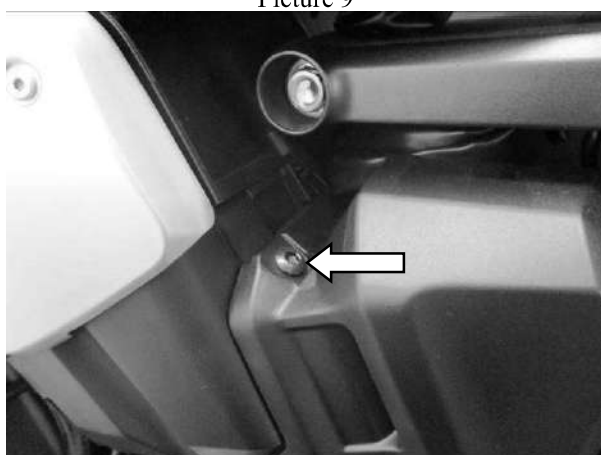

Picture 11



Picture 12

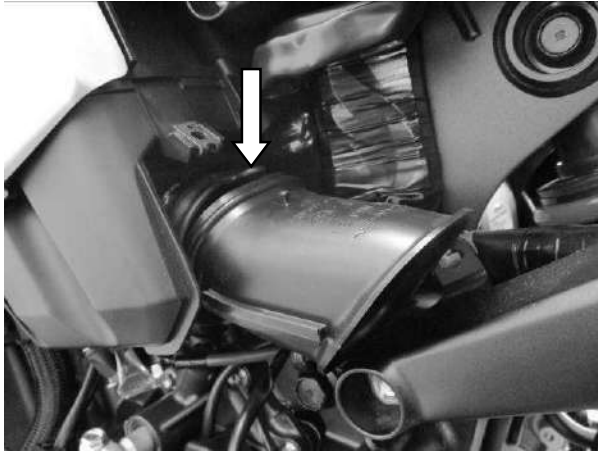

Picture 13



Picture 14

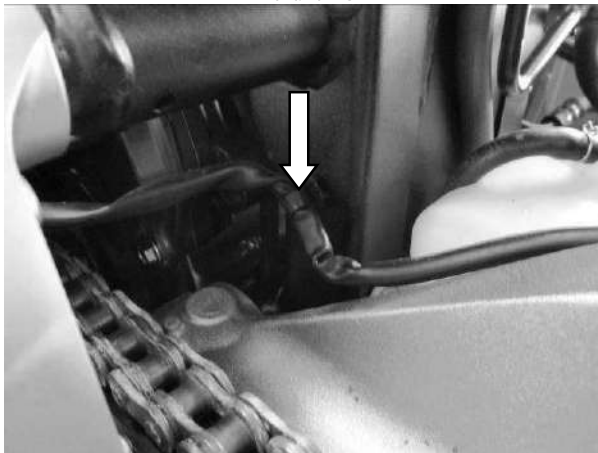

Picture 15

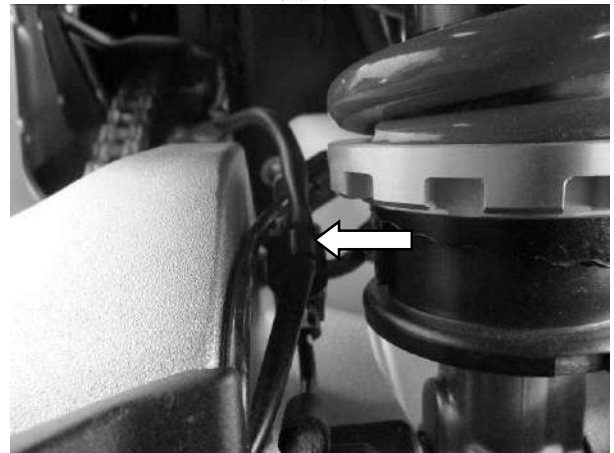

Picture 16

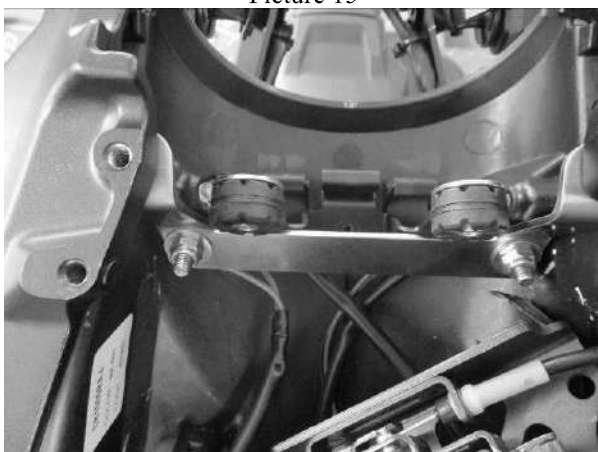

Picture 17



Picture 18



Picture 19



Picture 20



Picture 21



Picture 22



Picture 23



Picture 24



Picture 25



Picture 26



Picture 27



Picture 28

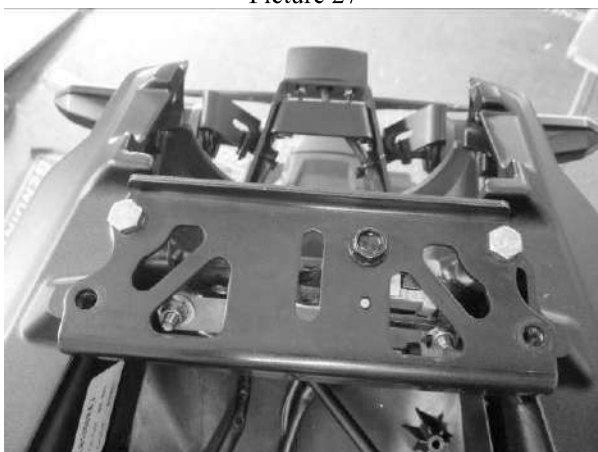

Picture 29



Picture 30

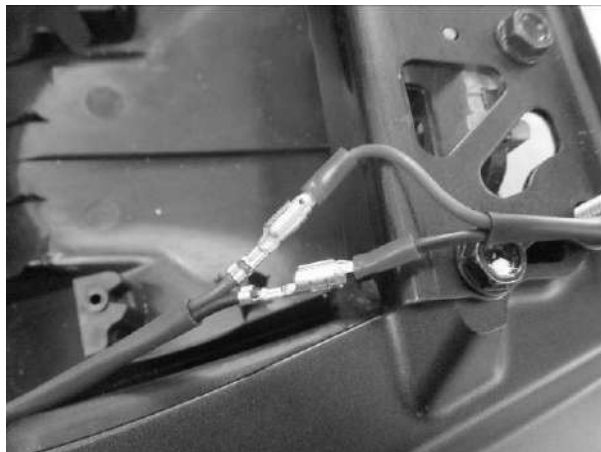

Picture 31

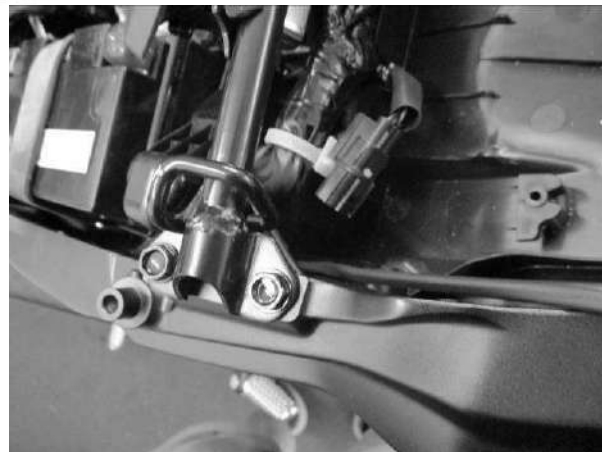

Picture 32



Picture 33

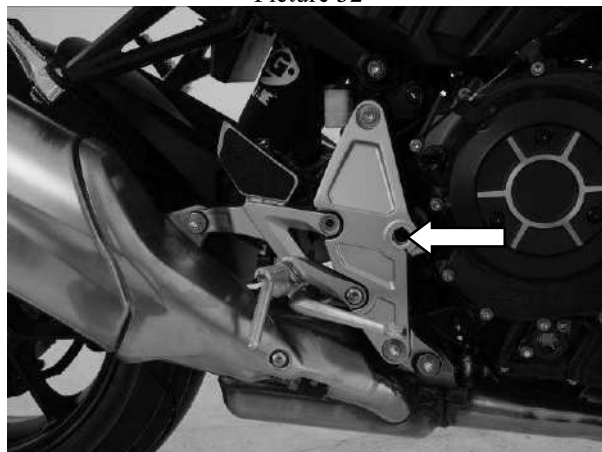

Picture 34

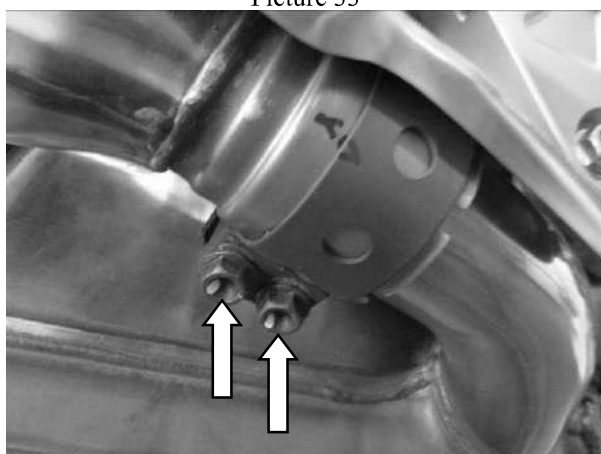

Picture 35

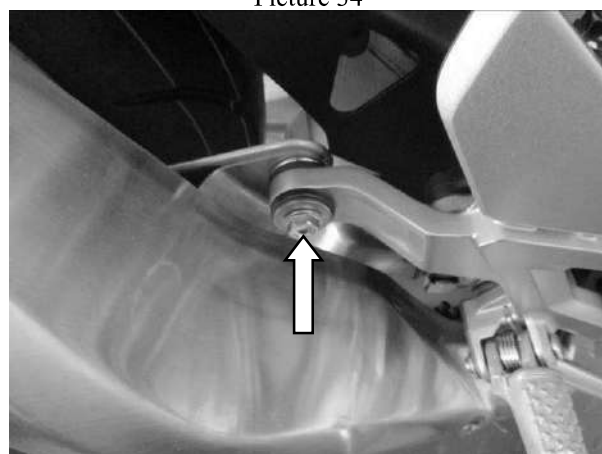

Picture 36



Picture 37

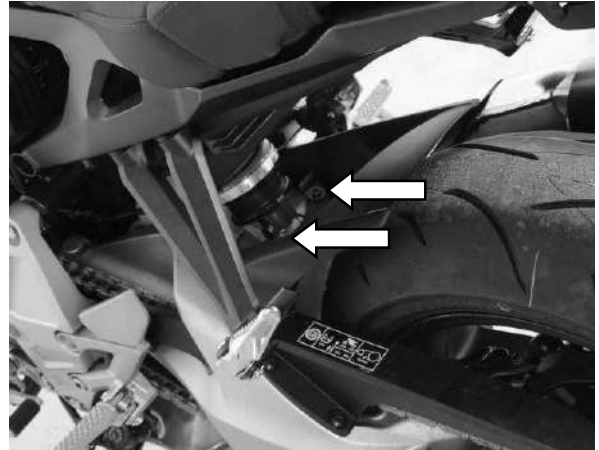

Picture 38

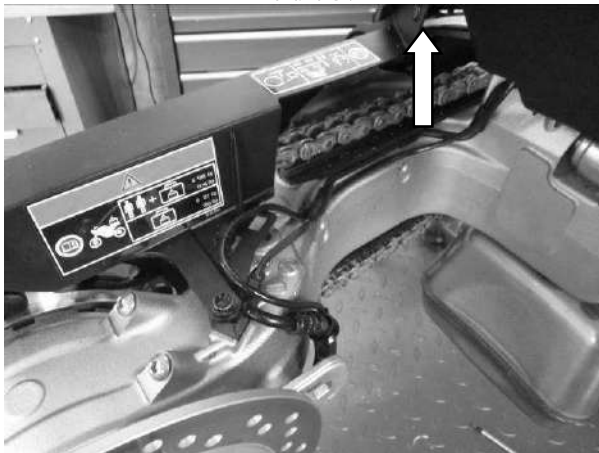

Picture 39



Picture 40

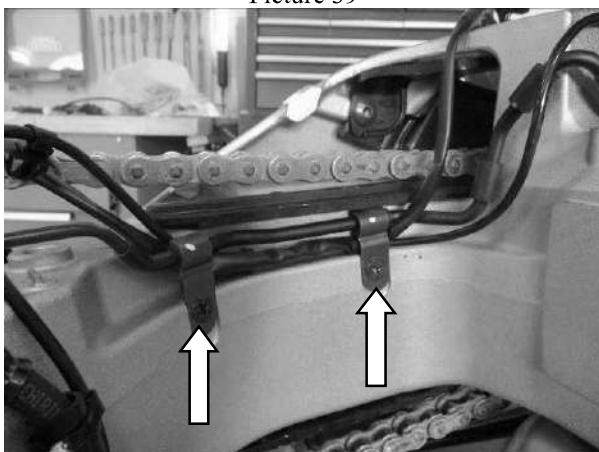

Picture 41

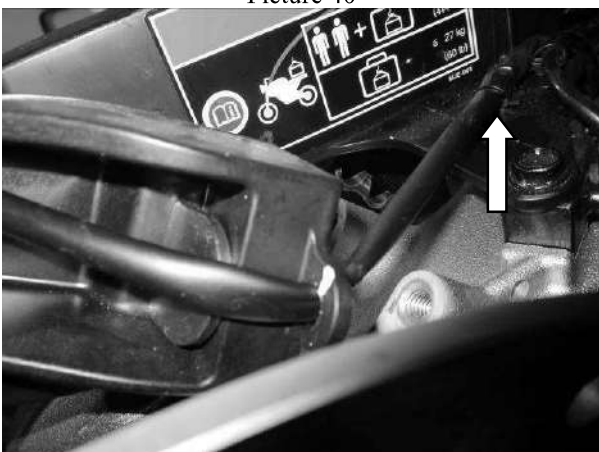

Picture 42



Picture 43

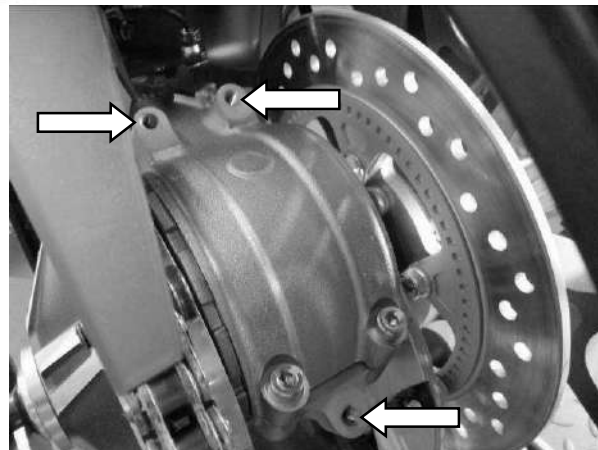

Picture 44



Picture 45



Picture 46



Picture 47



FITTING INSTRUCTIONS

- To fit the R&G tail tidy, remove the pillion seat using the motorcycle key as shown in **picture 1** and the main seat using the 2 bolts arrowed in **picture 2**.
- Remove the 4 bolts from the seat lock bracket shown in **picture 3** and place it to the side as shown in **picture 4**.
- Unplug the 4 connectors (2 white, 1 orange, 1 blue) shown in **picture 5**.
- Unplug the taillight connector shown in **picture 6**.
- Remove the 2 bolts shown in **pictures 7** and **8** from the light support bracket. Make a note of which colour wires correspond to which side of the bike and remove the indicators.
- Remove the 2 bolts from the taillight shown in **picture 9**. The taillight can now be removed from the bike.
- Locate the air intake cover panel arrowed in **picture 10** and remove the bolts from the upper and lower mounts shown in **pictures 11** and **12**.
- Unhook the clip from the top of the air intake and pull the air intake away from the airbox as shown in **picture 13**.
- Locate the wiring loom tucked behind the airbox shown in **picture 14** and unclip the orange and blue connectors.
- Unclip the 2 wiring clips shown in **pictures 15** and **16** by using a small flathead screwdriver to release the cable tie or lever the clip from the slot.
- Locate the internal support bracket (**item 2**) as shown in **pictures 17, 18** and **19**.
- Fit the indicator mount bracket (**item 3**) to the licence plate bracket (**item 1**) as shown in **picture 20** using the 2 shorter M5 bolts (**item 4**), 4x M5 washers (**item 11**) and 2x M5 nuts (**item 9**) as shown in **picture 21**.
- Fit the licence plate illuminator (**item 15**) as shown in **picture 22** using the included nuts and bolts. The shroud may require fitting using a small amount of superglue. Protect the wiring using a length of heat shrink (**item 21**).

If using OEM indicators

- Disassemble both indicator mounting assemblies by removing the bolt and the inner plastic shroud. Remove the metal insert now visible from the back of the indicator. Pull the indicator from the plastic outer of the indicator mounting bracket.
- Fit the indicators to the correct sides of the indicator bracket by pushing the rubber mounting through the hole, the right side should use the indicator with the blue connector and the left side the orange connector.
- Slide one of the indicator spacers (**item 17**) onto the inside of each indicator so that the mounting face of the indicator sits flush against the indicator bracket.
- Insert the metal insert removed earlier into the back of the indicator in the same way it was removed.
- Secure the indicators using the 2 longer M5 bolts (**item 5**).

If using mini-indicators (R&G product codes: RG371=LED, RG372=LED Aero, RG374=LED tear-drop)

- Mount the mini-indicators using 2 indicator adaptors (**item 16**) and 1 indicator spacer (**item 17**) per side as shown in **pictures 23** and **24**. The larger face of the outer indicator adaptor fits against the mini indicator with the smaller stepped face sitting

R&G

Unit 1, Shelley's Lane, East Worldham, Alton, Hampshire, GU34 3AQ

Tel: +44 (0)1420 89007 Fax: +44 (0)1420 87301 www.rg-racing.com Email: info@rg-racing.com



inside the indicator bracket. The indicator spacer fits between the inner indicator adaptor and the indicator bracket.

- Protect the wiring of the mini-indicators using a length of heat shrink (**item 21**) on each indicator.
- Slide an indicator wiring cover onto each indicator as shown in **picture 25**.

Standard fitting procedure

- Using one cable tie on each side secure the indicator wire to the bracket as shown in **picture 26**.
- Route the indicator and licence plate illuminator wires along the inside of the licence plate bracket, secure using cable ties and pass through the hole as shown in **picture 27**.
- Place 1 small M6 washer (**item 12**) onto 1 M6 cap head bolt (**item 6**) and offer this through the mounting holes on the licence plate bracket (**item 1**). Place 1 stepped spacer (**item 14**) onto this bolt with the larger face against the bracket as shown in picture 28. Repeat this for the other side.
- Offer this assembly up to the exposed indicator mounting holes on the tail of the bike ensuring that the bolts pass through the OEM light mount bracket and the internal support bracket (**item 2**).
- Loosely secure the tail bracket using 1 large M6 washer (**item 13**) and 1 M6 nyloc nut (**item 10**) per side as shown in **picture 17**.
- Replace the seat lock bracket as shown in **picture 29** and loosely secure using the M6 hex head bolts (**item 7**) in the rear 2 holes ensuring that these also pass through the internal support bracket (**item 2**). Use the original bolts for the front 2 holes.
- Wind the M6 bolts out until there is just enough thread showing beneath the internal support bracket to fit a small M6 washer (**item 12**) and M6 nyloc nut (**item 10**). Hold the M6 nut in position using a spanner while tightening the bolt through from above, this will make it easier to allow the thread to engage fully with the rear subframe of the bike and with the nut simultaneously. Ensure the nut is tight against the internal support bracket and the bolt is tight against the top of the subframe (maximum 15Nm of torque).
- Tighten the lower internal support bracket and licence plate bracket mounts.
- Route the wiring through the tail panel holes as shown in **picture 30**.
- Connect the licence plate illuminator extension (**item 19**) to the licence plate illuminator (**item 15**) connectors.
- Connect the licence plate illuminator connector (**item 18**) to the connectors of the extension as shown in picture **31**.
- Route this wiring down the left side of the rear subframe so that it does not interfere with other wiring as shown in **picture 32**.
- Push the wiring through the subframe as shown in **picture 33** and reconnect the connectors removed in **picture 14**.
- If fitting OEM indicators connect the indicator wiring to the wiring connectors in the same way they were removed (**picture 5**). The right-side connectors should be blue & white and the left side orange & white.
- If fitting mini-indicators connect the bullet connectors to the indicator connectors (**item 18**) and then to the bike connectors (**picture 5**). The right-side connectors should be blue & white and the left side orange & white.

R&G

Unit 1, Shelley's Lane, East Worldham, Alton, Hampshire, GU34 3AQ

Tel: +44 (0)1420 89007 Fax: +44 (0)1420 87301 www.rg-racing.com Email: info@rg-racing.com



- Test the indicators and licence plate illuminator for correct function and flash rate, if lights fail to work correctly, swap the connectors.

To remove the Honda tail unit without cutting the number plate light wire the rear wheel must be removed. This requires use of a suitable swingarm pivot stand mounted on both sides in the pivot point shown in **picture 34**.

If removing the rear wheel

- Remove the exhaust silencer by loosening the two clamp bolts in **picture 35**. Do not completely remove these bolts.
- Remove the nut and bolt supporting the exhaust (**picture 36**) from the rear of the footrest while supporting the exhaust.
- Slide the exhaust away from the bike.
- Slightly loosen the 5 wheel nuts shown in **picture 37**.
- Lift the bike using a swingarm pivot stand.
- Remove the rear wheel by undoing the 5 wheel nuts.
- Remove the two bolts holding the wheel mudguard shown in **picture 38**.
- Remove the pop rivet holding the chainguard to the mudguard shown in **picture 39**.
- There is a small L shaped bracket located below the left side mudguard bolt that is likely to fall out when the mudguard is removed, this must be replaced between the mudguard and swingarm in the orientation shown in **picture 40**.
- Remove the 2 Philips head screws holding the 2 small brackets shown in **picture 41**.
- Remove the cable clip arrowed in **picture 42** holding the wire that goes into the tail unit.
- Check that the number plate light wire is now completely free from all clips and brackets holding it to the swingarm.
- Remove the 3 bolts holding the tail unit to the swingarm, the location of these bolts when removed is shown in **picture 44**.
- Remove the tail unit.
- Fill the 3 exposed holes with the 3 M8 bolts (**item 8**).
- Refit the 2 brackets in **picture 41**, small L bracket and mudguard (**picture 38 & 40**), wheel and exhaust in the reverse of the order they were removed.
- The bike can be lowered from the swingarm pivot stand if convenient.

If leaving the rear wheel in place

- Remove the two bolts holding the wheel mudguard shown in **picture 38**.
- Remove the pop rivet holding the chainguard to the mudguard shown in **picture 39**.
- There is a small L shaped bracket located below the left side mudguard bolt that is likely to fall out when the mudguard is removed, this must be replaced between the mudguard and swingarm in the orientation shown in **picture 40**.
- Cut the number plate light wire shown in **picture 45** close to the clip that holds it to the chainguard as indicated by arrows in **picture 45**.
- Remove the 3 bolts holding the tail unit to the swingarm, the location of these bolts when removed is shown in **picture 44**. The upper left side bolt is accessible from the left side of the bike and the other two bolts are accessible through the wheel from the right side.

R&G

Unit 1, Shelley's Lane, East Worldham, Alton, Hampshire, GU34 3AQ

Tel: +44 (0)1420 89007 Fax: +44 (0)1420 87301 www.rg-racing.com Email: info@rg-racing.com